



810 WEST WASHINGTON BOULEVARD
CHICAGO, IL 60607

8566 KRUM AVENUE
GALESBURG, MI 49053

KALAMAZOOGOURMET.COM
+1.800.868.1699

Echo 3 Built-In Gas Grill



PRODUCT FEATURES

- 24" x 22" (528 square inches) of primary grilling surface
- Two primary burners, 23,000 BTUs each (LP)
- Natural gas, bulk liquid propane or 20-pound liquid propane cylinder (with ventilated base cabinet)
- Rotisserie system with infrared burner; motor mounted in chassis
- Electronic control bezels with flame sensor LED indicators
- Interior task lighting
- Three-position warming rack with stowage
- Optional heavy duty laser-cut cooking surfaces
- Convenient cleanout system with two, separate, one-inch-deep trays
- Marine-grade stainless steel available

| | |
|---------------------------------------|--|
| Overall Width / Installation Width | 32.25 in (820 mm) / 30 in (762 mm) |
| Overall Depth / Installation Depth | 30.5 in (776 mm) / MIN. 24.25 in (616 mm); MAX. 25.375 in (645 mm) |
| Overall Height / Above Counter Height | 29.5 in (749 mm) / 18.125 in (461 mm) |
| Approximate Product Weight | 300 lb (136 kg) |
| Gas Requirements | Natural Gas: 1/2" (13 mm) male NPT connection. 10 ft. (305 cm) gas hose with quick disconnect provided. Gas service line to deliver 7 i.w.c. at grill location. See BTU information below for pipe sizing. |
| | Bulk Propane: 1/2" (13 mm) male NPT connection. 10 ft. (305 cm) gas hose with quick disconnect provided. Gas service line to deliver 11 i.w.c. at grill location. See BTU information below for pipe sizing. |
| | Propane Cylinder: 20-pound (9 kg) propane cylinder with provided 2 ft. (61 cm) gas hose with dual regulator. Requires an appropriately-ventilated cylinder enclosure or optional Kalamazoo base cabinet K-DBC42-LVP |
| Electrical Requirements | 120VAC/60Hz Includes 1 ft. (30.5 cm) 3-prong grounded power cord. |
| Maximum AMP usage | 3 amps |
| Main Burners Rating | 46,000 BTU liquid propane / 50,000 BTU natural gas |
| Total BTUs | 51,000 BTU liquid propane / 57,500 BTU natural gas |

Ensure proper gas pipe sizing. Diameter and length of the supply pipe may limit the pressure and BTU delivery.

This appliance is certified to the ANS Z21.58/CSA 1.6 (2018) standard for Outdoor Cooking Gas Appliances.

As with all appliances certified to this standard, this appliance is for outdoor use only and may not be used underneath an overhead combustible structure or surface.

Maintain at least 6 inches (153 mm) of clearance between the sides and back of the grill and any combustible surface.

High altitude kit available.

Do not place the grill in a location where the rear hood openings are likely to be exposed to strong wind. A wind break wall is recommended for installations where the prevailing wind may be a problem.

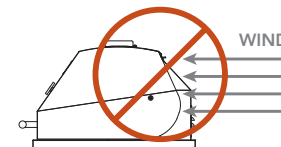

WARNING: This product can expose you to chemicals including nickel, which are known to the State of California to cause cancer, and lead, which is known to the State of California to cause birth defects or other reproductive harm. For more information go to www.P65Warningsca.gov



810 WEST WASHINGTON BOULEVARD
CHICAGO, IL 60607

8566 KRUM AVENUE
GALESBURG, MI 49053

KALAMAZOOGOURMET.COM
+1.800.868.1699

Echo 3 Built-In Gas Grill

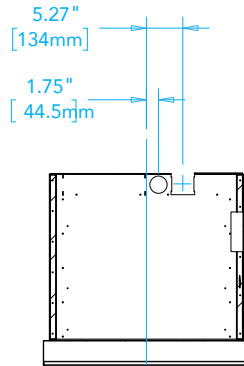

SECTION A-A
"CHASSIS" DIMENSIONS

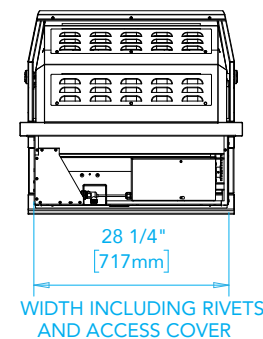
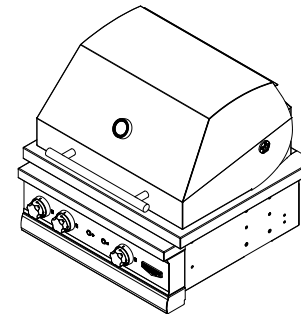
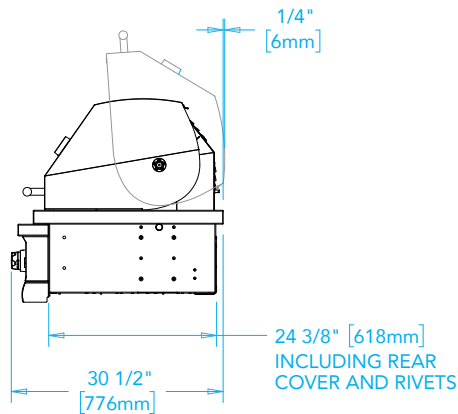
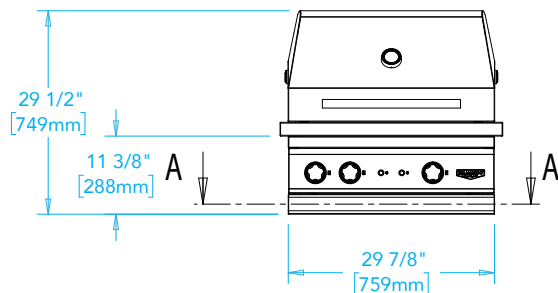
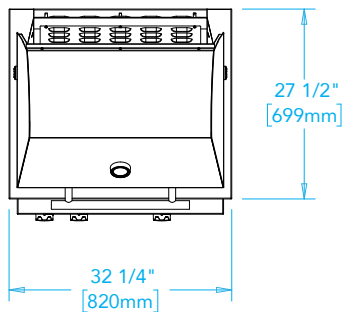



810 WEST WASHINGTON BOULEVARD
CHICAGO, IL 60607

8566 KRUM AVENUE
GALESBURG, MI 49053

KALAMAZOOGOURMET.COM
+1.800.868.1699

Notice for Countertop Fabricators

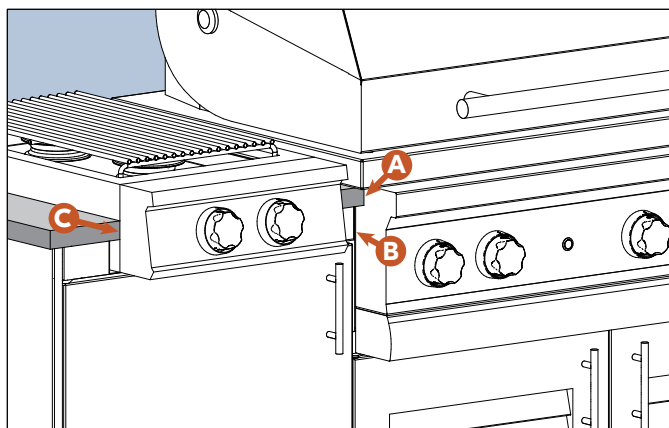

Echo Grill shown in optional Kalamazoo base cabinet.

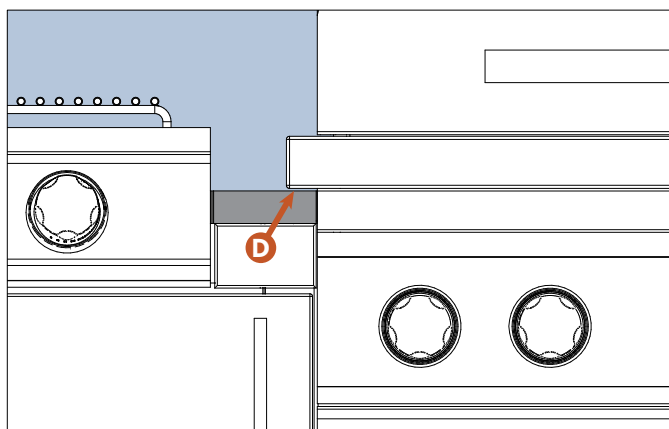

The countertop should be adhered directly to the tops of the cabinets using silicone adhesive. See detailed instructions in the cabinetry installation manual.

A 1-inch overhang is recommended on all sides. The recommended position of the Kalamazoo Echo Grill will notch the front edge of the countertop 1 inch around the control panel. **A** The countertop should extend below the trim ledge of the grill behind the control panel.

The back plane of the control panel should be flush with the front plane of the cabinetry or other base structure. **B**

The seam between the control panel and the body of the Kalamazoo cooktop **C** should be in front of the countertop.

When the Echo Grill is installed in the Kalamazoo base cabinet, the grill support pads should be adjusted to create a 1/8 inch (3mm) gap between the top of the countertop and bottom of the grill trim ledge. **D** Drop-in grills that are not installed in Kalamazoo cabinetry may rest directly on the countertop.

A drip edge **E** is recommended around the perimeter of the countertop.

Undercounter refrigeration **F** should not bear the load of, or be adhered to the countertops.

The optimum recommended countertop thickness when using the Kalamazoo base cabinet with the Echo drop-in grill is 1.25 inches (32mm). Maximum is 2 inches (51mm). Minimum is 1 inch (25mm).

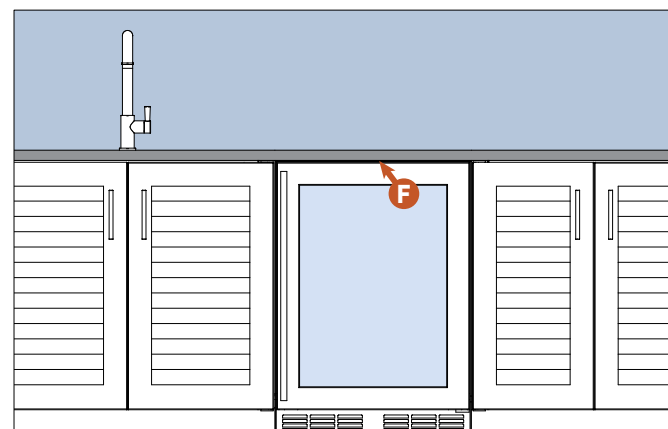
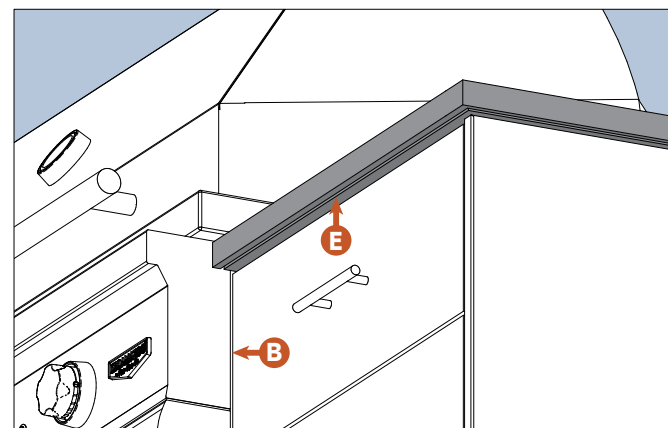



810 WEST WASHINGTON BOULEVARD
CHICAGO, IL 60607

8566 KRUM AVENUE
GALESBURG, MI 49053

KALAMAZOOGOURMET.COM
+1.800.868.1699

Echo 3, 4, 5 Built-In Gas Grill Cutout Dimensions

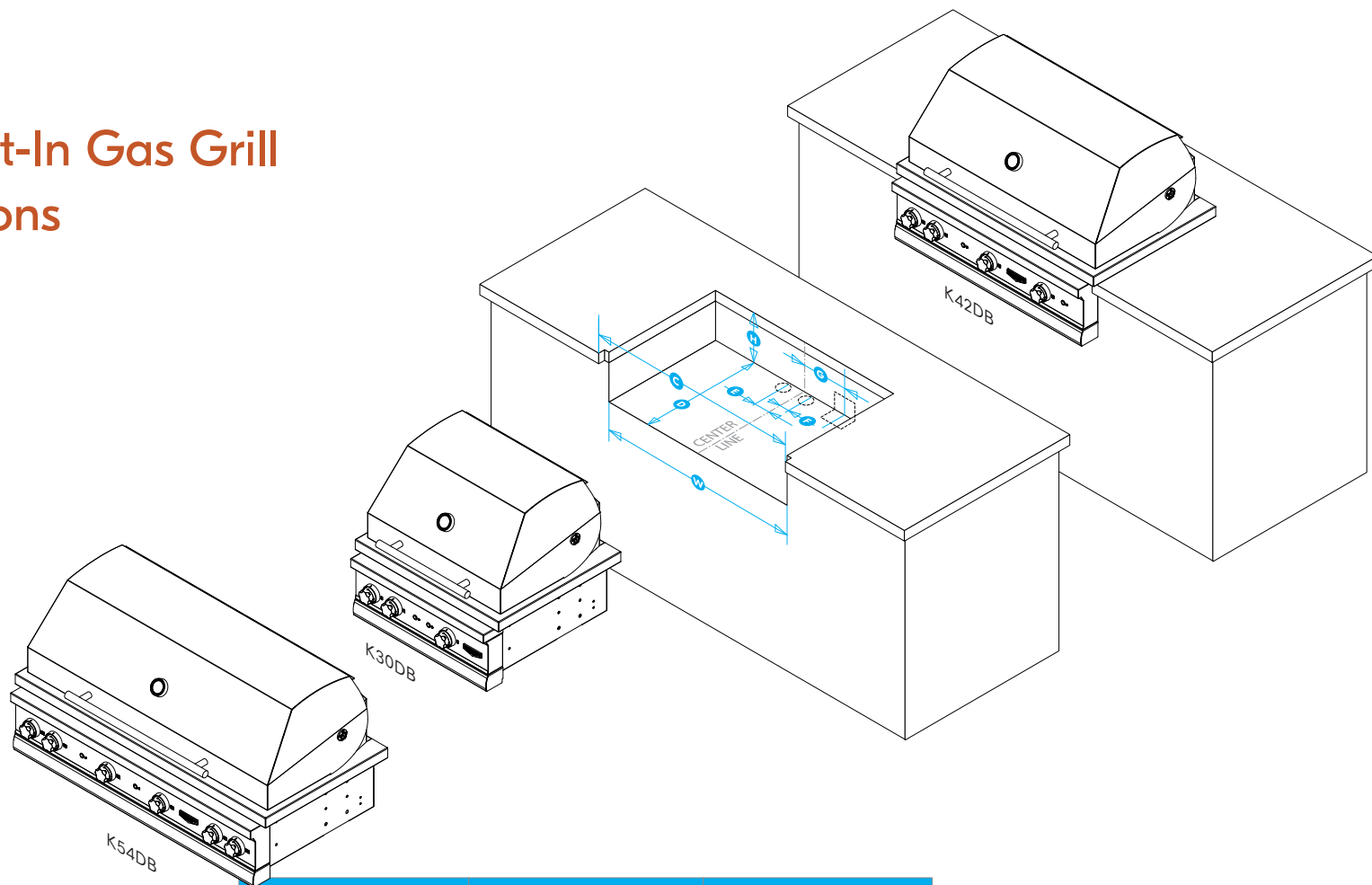

| | ECHO 3 (K30DB) | | ECHO 4 (K42DB) | | ECHO 5 (K54DB) | | |
|---|-----------------|------------------|------------------|------------------|------------------|------------------|--|
| DIMENSION | MINIMUM | MAXIMUM | MINIMUM | MAXIMUM | MINIMUM | MAXIMUM | NOTES |
| W PRIMARY CUTOUT WIDTH | 28.25" / 718 mm | 29.5" / 750 mm | 40.25" / 1023 mm | 41.5" / 1054 mm | 52.25" / 1328 mm | 53.5" / 1359 mm | MAIN CHASSIS WIDTHS: K30DB 28.125" / 715 mm; K42DB 40.125" / 1020 mm; K54DB 52.125" / 1324 mm |
| H PRIMARY CUTOUT HEIGHT | 10" / 254 mm | 11.675" / 297 mm | 10" / 254 mm | 11.675" / 297 mm | 10" / 254 mm | 11.675" / 297 mm | MAIN CHASIS IS 10" / 254 mm TALL |
| D PRIMARY CUTOUT DEPTH | 24.25" / 616 mm | 25.375" / 645 mm | 24.25" / 616 mm | 25.375" / 645 mm | 24.25" / 616 mm | 25.375" / 645 mm | FROM FACE OF STRUCTURE, NOT INCLUDING COUTNERTOP OVERHANG |
| C FRONT COUNTERTOP NOTCH WIDTH | 30" / 762 mm | NA | 42" / 1067 mm | NA | 54" / 1372 mm | NA | REQUIRED IF THERE IS A FRONT COUTNERTOP OVERHANG |
| G GAS HOSE ENTRANCE CENTER LINE | 5.27" / 134 mm | NA | 9" / 229 mm | NA | 15" / 381 mm | NA | 5" / 127mm OPENING FOR GAS CONNECTION. HOSE MAY PASS THROUGH REAR OR BOTTOM AS NEEDED |
| E ECHO 4, 5 ELECTRICAL CORD PASS-THROUGH | | | 3.14" / 80 mm | NA | 9.14" / 232 mm | NA | 4" / 102mm OPENING REQUIRED FOR GROUNDED ELECTRICAL EXTENSION CORD CENTERED 2" / 51mm TO 3" / 76mm FROM REAR OF CUTOUT |
| F ECHO 3 ELECTRICAL CORD PASS-THROUGH | -1.75" / -44 mm | NA | | | | | 4" / 102mm OPENING REQUIRED FOR GROUNDED ELECTRICAL EXTENSION CORD CENTERED 2" / 51mm TO 3" / 76mm FROM REAR OF CUTOUT |



810 WEST WASHINGTON BOULEVARD
CHICAGO, IL 60607

8566 KRUM AVENUE
GALESBURG, MI 49053

KALAMAZOOGOURMET.COM
+1.800.868.1699

Optional K-DIJK30 Insulating Jacket for Echo 3 Built-In Gas Grill

PRODUCT FEATURES

- Purchased separately
- Allows for installation of grill adjacent to combustible cabinetry or framing below a non-combustible countertop
- Double-walled stainless steel construction
- Marine-grade stainless steel available

| | |
|------------------------------------|---|
| Overall Width / Installation Width | 32.25 in (1124 mm) / 32.375 in (1128 mm) |
| Overall Depth / Installation Depth | 25.45 in (647 mm) / 25.5125 in (648 mm) |
| Height (Flush with Countertop) | 12 in (305 mm) |
| Countertop Cutout | 32.375 in (823 mm) WIDE x 25.5 in (648 mm) DEEP |
| Countertop Thickness Allowed | Any |
| Approximate Product Weight | 53 lb (24 kg) |

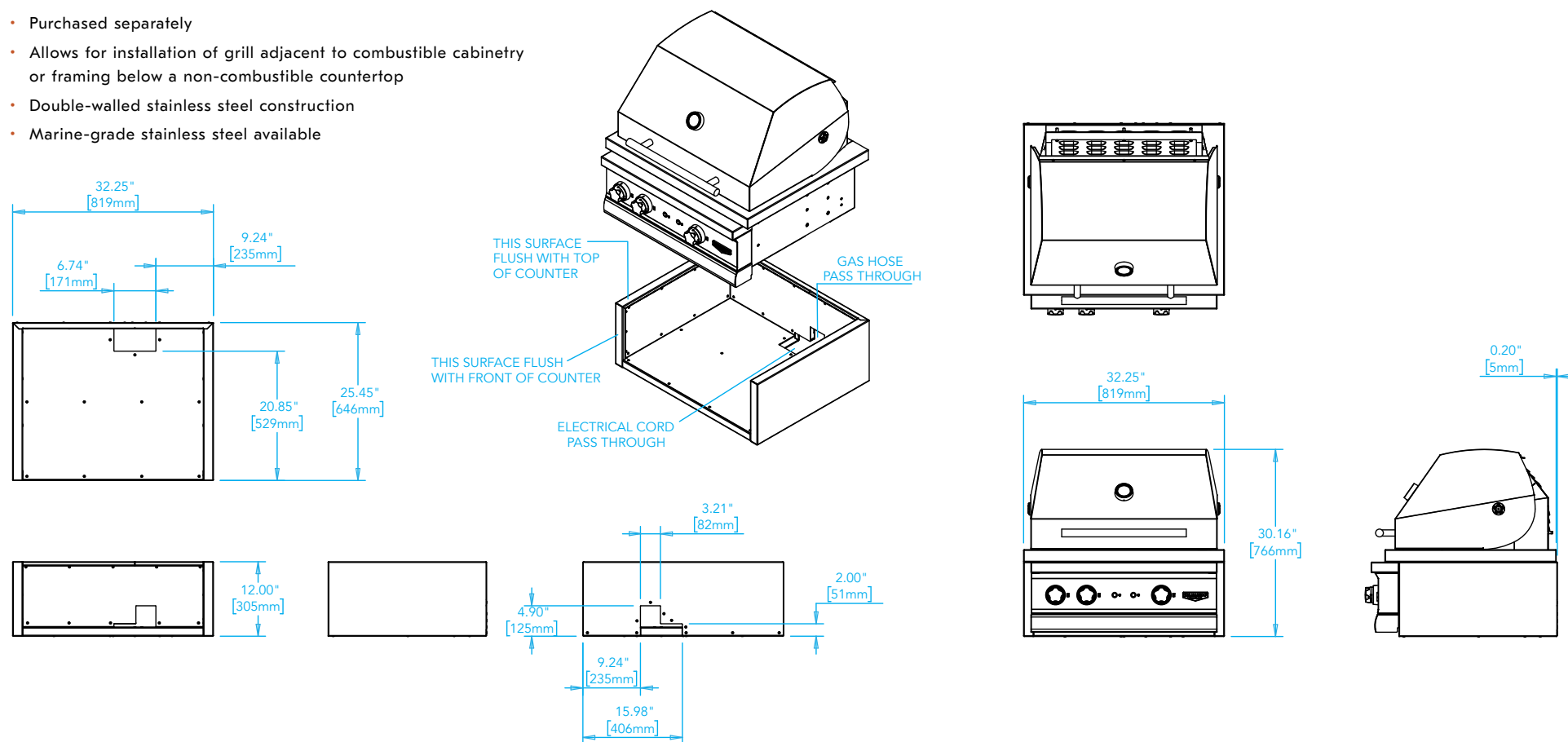

WARNING: This product can expose you to chemicals including nickel, which are known to the State of California to cause cancer, and lead, which is known to the State of California to cause birth defects or other reproductive harm. For more information go to www.P65Warningsca.gov